

# TURBOMACHINERY INLET SILENCERS

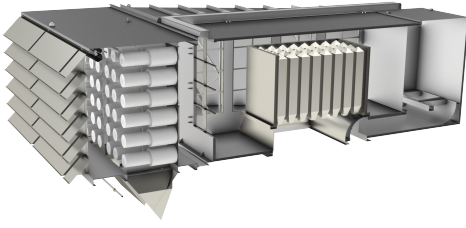

## ADVANTAGES

- Maintains a low and stable pressure drop
- Dampens noise from turbomachinery
- Designed to your specific requirements

---

## Application

Turbomachinery Systems such as gas turbines, large industrial air compressors, diesel & gas engines, generators

---

## Installation Options

Our casing designs are either internally lined or externally cladded. Baffles can be splitter type in SST, galvanized or aluminum or modular "brick" type in SST. We also offer tube silencers.

---